

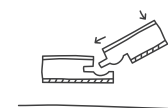

**F** **FLOATING**  
 design floating floor



Embossed Wearlayer  
 with PU finishing  
 Design film  
 Comfort layer  
 High-density fiberboard  
 Comfort & Acoustic Cork Backing



# Floating floor with a strong Click System



CLASS **32**



COLLECTIONS	ORIGINALS	XL SLATE	STONE	TREND
Dimensions EN 427 / Thickness EN 428	1200 x 210 x 9,5 mm	1200 x 440 x 10,8 mm	612 x 440 x 10,8 mm	1200 x 210 x 8,7 mm
Impact Sound Reduction en 140	18 dB	18 dB	18 dB	17 dB
Emboss / Surface	Deep Wood Super-matte	Regular Slate Semi-matte	Regular Stone Semi-matte	Regular Wood Semi-matte
Classification EN 16511	32	32	32	32
Weight EN 430	11 kg/m <sup>2</sup>	11 kg/m <sup>2</sup>	11 kg/m <sup>2</sup>	11 kg/m <sup>2</sup>
Fire Performance EN 13501			Bfl - s1	
Anti-sliding properties EN 13893			Class DS	
Formaldehyde emission EN 717-1			Class E1	
Content of PCP CEN / TR 14823			Not to declare	
Dimensional Stability after exposure to heat EN ISO 23999:2012			-0.1%	
Abrasion Resistance EN 15468, Annex A			2500	
Static Indentation EN ISO 24343			0,04 mm	
Resistance against impact (big ball) EN 13329			No visible change	
Chemical Resistance EN 433			Class 0	
Determination of the effect of a castor chair EN 425			No visible change	
Determination of the effect of a furniture eg EN 424			No visible change	
Microscratch resistance EN 16094			MSR-A2 / MSR-B1	
Resistance against staining according to EN 438-2:2016			Coffee: grade 5 / NaOH: grade 4 / H2O2: grade 5 / Shoe polish: grade 5 / Shoe polish: grade 5	
Locking strenght ISO 24334:2006				
- short side joints			5.8 kN/m	
- long side joints			6.9 kN/m	
Underfloor Heating			Approved 27°C	
Thermal Resistance EN 12524			0,088 m <sup>2</sup> /W	
Emissions Value			In conformity with AgBB	
Resistance to Fading ISO 105 B02			6/8 Good	

